

**Product Data Sheet**

**G12MF, MM, FM Type 2 Valve Manifold**

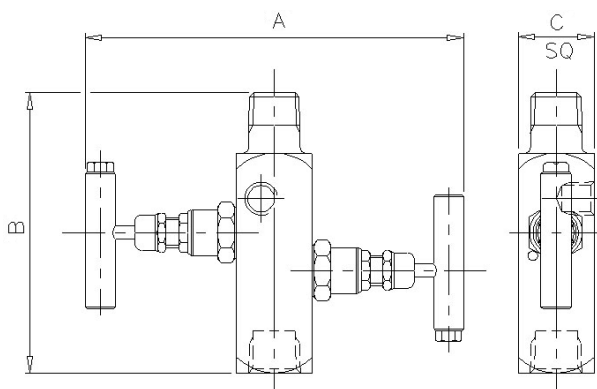

The 'G12' Type 2 valve manifold is designed for remote mounting to static pressure transmitters. The separate vent valve gives full control of venting of the instrument, plus the ability to calibrate in-situ. Each needle valve head is designed for safe and reliable isolation, giving bubble tight shut off, with non-rotating & anti-galling tip and dynamic self-adjusting spindle seal to give long service life in a variety of service conditions.

| Part No. | Connections Size | A   | B   | C   | Weight (Kgs) |
|----------|------------------|-----|-----|-----|--------------|
| G12MF    | ½" M x F         | 6.3 | 4.6 | 1.3 | 0.9          |
| G12MM    | ½" M x M         | 6.3 | 5.4 | 1.3 | 0.9          |
| G12FM    | ½" F x M         | 6.3 | 4.6 | 1.3 | 0.9          |

**Key Features of the Oliver Needle Valve range**

- Non rotating tip - self centering & anti-galling
- Piston ring - gives dynamic adjustment of gland seal in response to pressure change
- Anti-blow out spindle - a major safety feature
- Secure seal - precision machined to give leak free operation for the life of the valve. Available in either PTFE or Grafoil

**Standard Specification**

|                                 |                  |                          |                     |
|---------------------------------|------------------|--------------------------|---------------------|
| Pressure: 6000psi               | Packing: PTFE    | Handle: T-Bar            | Bore: 0.21" (5.4mm) |
| Temp: 240 deg C                 | Thread form: NPT | Seat: Metal to metal     | CV: 0.46            |
| 1/2" Inlet / Outlet Connections |                  | 1/4" NPT Vent Connection |                     |

**Ordering Code**

|  |  |  |          |           |          |           |
|--|--|--|----------|-----------|----------|-----------|
| (Typical example) → <b>G12MF</b>   |  | <b>S</b>   | <b>/</b> | <b>BT</b> | <b>/</b> | <b>AT</b> |
| <b>Type</b>  |  |  |          |           |          |           |
| G12MF - Male x Female<br>G12MM - Male x Male<br>G12FM - Female x Male  |  |  |          |           |          |           |
| <b>Material</b>  |  |  |          |           |          |           |
| S - 316S31 Stainless Steel<br>M - Monel (400)  |  | HC - Hastalloy (C276)<br>(Others available)  |          |           |          |           |
| <b>Optional Connections (NPT Standard)</b>   |  |  |          |           |          |           |
| BT - BSP Taper<br>BP - BSP Parallel (top sealing)<br>BTV - BSP Taper Vent  |  | BPV - BSP Parallel Vent<br>BW-SCH*** - Butt weld (Schedule ***)<br>MSW - Male Socket Weld  |          |           |          |           |
| <b>Options</b>   |  |  |          |           |          |           |
| AG - Grafoil<br>AT - Anti-Tamper<br>BKTC - Carbon steel mounting bracket<br>BKTS - Stainless steel mounting bracket<br>HL - Handle Locking<br>HL-PI - Handle Locking + Position Indicator<br>HW - Hand Wheel<br>LT100 - Cryogenic Head Unit (-100°C) |  | MT - Metering Tip<br>MTG - Tapped Mounting Holes x 2<br>NA - NACE MR-01-75 (latest revision)<br>OXY - Oxygen Cleaned<br>PK - PEEK Soft Tip<br>PP - Blank Plug In Vent Connection<br>2H - Straight through mounting holes x 2 |          |           |          |           |

Rev 1.1

Oliver Valves Ltd, Parkgate Industrial Estate, Knutsford, Cheshire, WA16 8DX. United Kingdom.

T: +44 (0)1565 632636 E: [sales@valves.co.uk](mailto:sales@valves.co.uk) W: [www.valves.co.uk](http://www.valves.co.uk)

© Oliver Valves Ltd 2009